

# SECTION OS-FS-1

## LVS 210 FIRE SUPPRESSION SYSTEM ASSEMBLY AND INSTALLATION

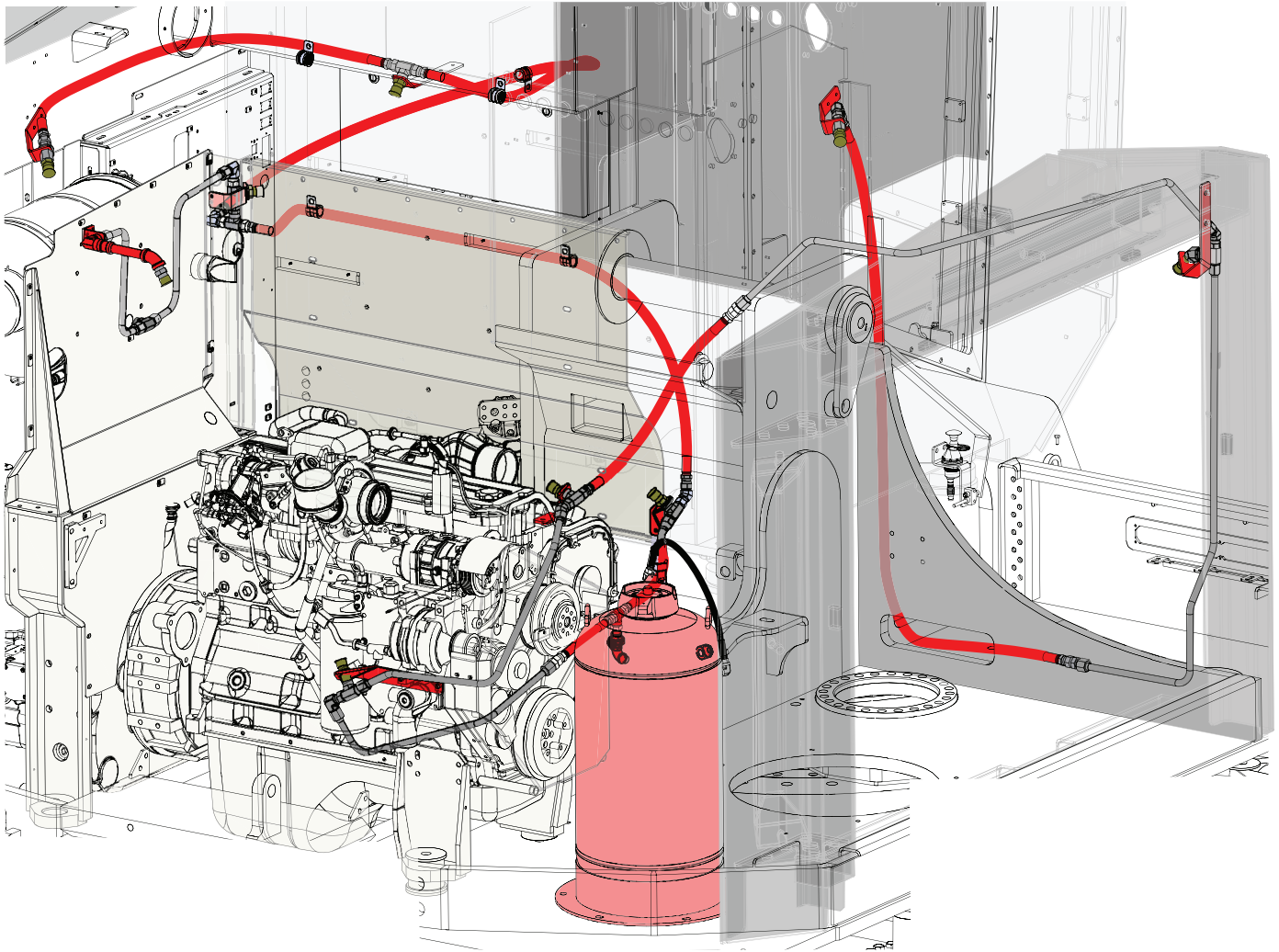

# LVS 210 FIRE SUPPRESSION SYSTEM ASSEMBLY AND INSTALLATION

## CHEMICAL AGENT SYSTEM - TUBE, FITTING, AND BRACKET LAYOUT

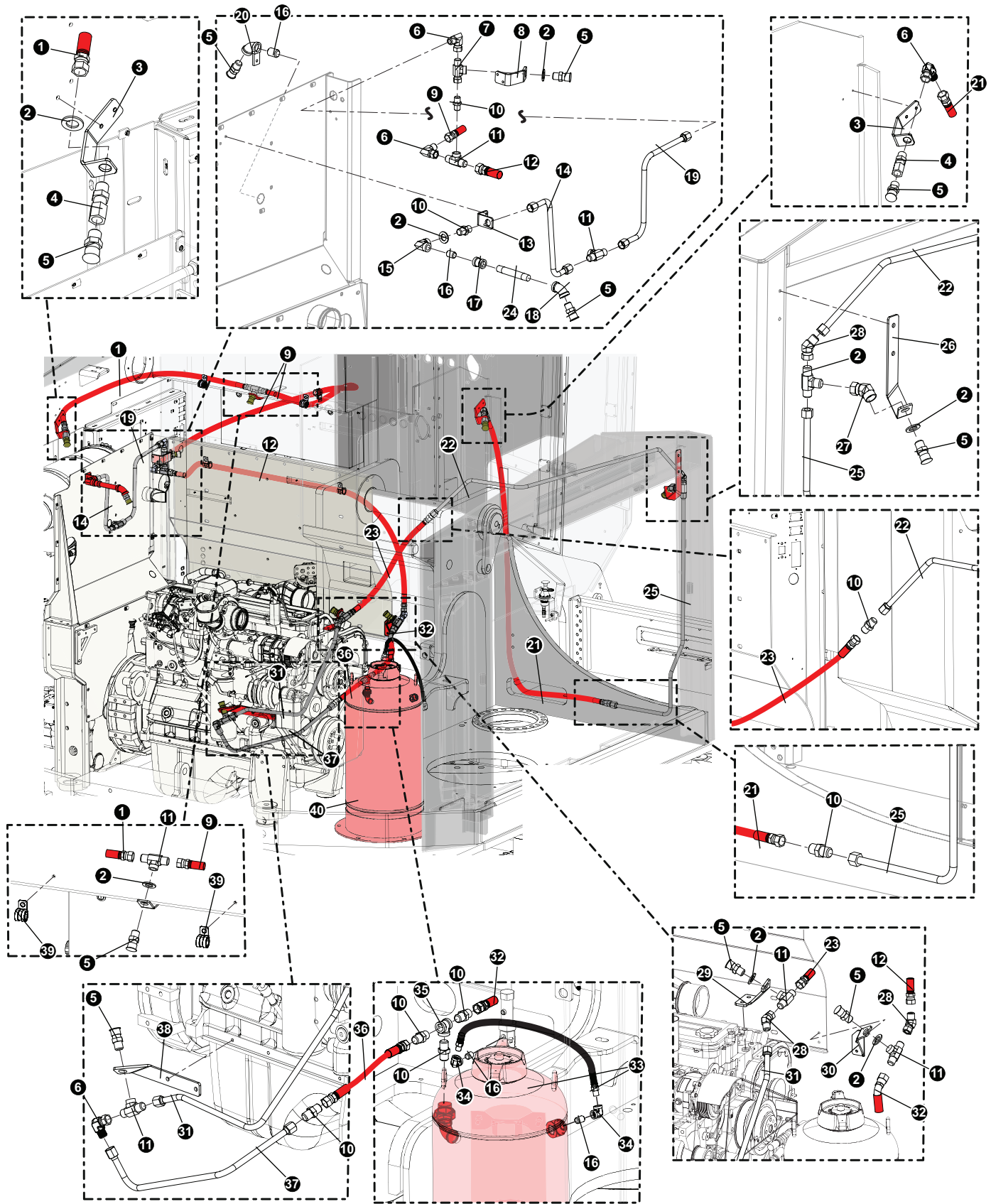

# LVS 210 FIRE SUPPRESSION SYSTEM ASSEMBLY AND INSTALLATION

## CHEMICAL AGENT SYSTEM - TUBE, FITTING, AND BRACKET LAYOUT

ITEM #	PART #	QTY.	DESCRIPTION	ITEM #	PART #	QTY.	DESCRIPTION
1	58978 (Kit#)	1	Hose, <b>421FS 48 08-10JS-10JS</b>	25	58986	1	TUBELINE, FIRE SUPP - RAD FILLER PANEL
2	42110	9	WASHER, FLAT - 20MM	26	48621	1	BRACKET, FIRE SUPPRESSION ROTARY MANIFOLD
3	48617	1	BRACKET, FIRE SUPPRESSION - PUMPS	27	51911		ELBOW, STREET 45 .5" - FIRE SUPPRESSION
4	55357	1	FITTING, 10 WGTX-WLN-S	28	15241	1	ELBOW, 45 SWIVEL - 6502-10
5	433325	10	LVS 9.5 NOZZLE W/ BLOW OFF CAP ( <b>VAN'S PART #</b> )	29	60827	1	BRACKET, FIRE SUPPRESSION - BELT
6	55387	7	FITTING, SWIVEL - 10 C6X-S	30	47415	1	BRACKET, FIRE SUPPRESSION-PUMPS
7	51879	1	TEE, RUN - .5" (1/2 MRO-S)	31	58988	1	TUBELINE, FIRE SUPP - ALTER. TO CYL HEAD
8	62085	1	BRACKET, FIRE SUPP NOZZLE	32 (See Description)	1	Hose, <b>421FS 15 08-10JS-10J4</b>	
9	58978 (Kit#)	1	Hose, <b>421FS 70 08-10JS-10JS</b>	33	438775	1	15 GAL Wet Chemical Tank w/ Mounted Nitrogen Tank and Hose
10	57382	7	FITTING, 10 FTX-S	34	17370	3	ELBOW, 90 DEG 1/2 X 1/2 FEMALE
11	55424	8	FITTING, FEMALE BRANCH TEE	35	55377	1	TEE, FIRE SUPPRESSION - 3/4" NPT
12 (See Description)	1	Hose, <b>421FS 60 08-10JS-10JS</b>	36 (See Description)	1	Hose, <b>421FS 15 08-10JS-10JS</b>		
13	60464	1	BRACKET, FIRE SUPPRESSION - BELT SHROUD	37	58989	1	TUBELINE, FIRE SUPP - ALTER TO LVS TANK
14	60461	1	TUBE, FIRE WALL REAR - D-SERIES	38	60826	1	BRACKET, FIRE SUPPRESSION - ENGINE
15	17370	3	ELBOW, 90 DEG 1/2 X 1/2 FEMALE	39	16119	2	CLAMP, HOSE - COATED STRAP - 1"
16	16126	4	NIPPLE, CLOSE - 1/2"				
17	58018	1	COUPLING, PIPE - 1/2" MERCHANT GALVANIZED				
18	58017	2	ELBOW, PIPE - 1/2" 45 DEGREE GALVANIZED				
19	60460	1	TUBE, FIRE WALL FRONT - D-SERIES				
20	53595	1	MANIFOLD, FIRE SUPP. 45 DEGREE ELBOW				
21	58978	1	Hose, <b>421FS 50 08-10JS-10JS</b>				
22	58987	1	TUBELINE, FIRE SUPP. - RADIATOR TOP				
23	58978 (Kit#)	1	Hose, <b>421FS 29 08-10JS-10JS</b>				
24	58015	1	NIPPLE, PIPE - 1/2" x 5" GALVANIZED				

# LVS 210 FIRE SUPPRESSION SYSTEM ASSEMBLY AND INSTALLATION

## CHEMICAL AGENT SYSTEM - TUBE, FITTING, AND BRACKET LAYOUT

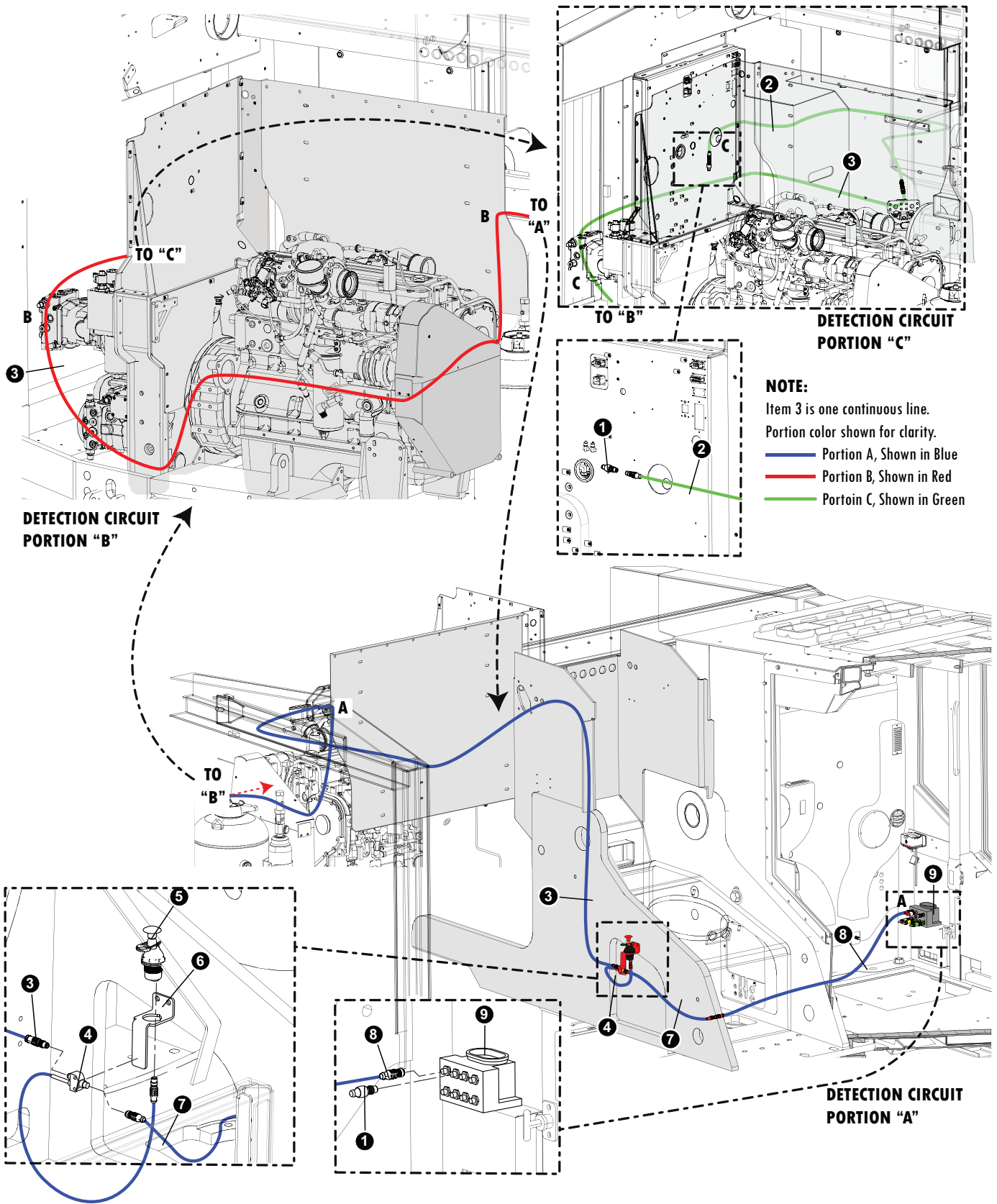

## LVS 210 FIRE SUPPRESSION SYSTEM ASSEMBLY AND INSTALLATION

### EMISSION SYSTEM - CONTROL MODULE AND CABLE LAYOUT

ITEM #	PART #	QTY.	DESCRIPTION
1	(See Description)	1	Detection Circuit, End of Line (EOL) Connector ( <b>Supplier #439396</b> )
2	(See Description)	1	10' Detection Circuit Cable ( <b>Supplier #439480</b> )
3	(See Description)	1	30' Detection Circuit Cable ( <b>Supplier #439410</b> )
4	(See Description)	1	Y Connector ( <b>Supplier #440152</b> )
5	(See Description)	1	Electric Manual Actuator Ship Assy. ( <b>Supplier #439400</b> )
6	(See Description)	1	EMA Bracket ( <b>Supplier #440537</b> )
7	(See Description)	1	Detection Circuit Cable-2' Cable ( <b>Supplier #439384</b> )
8	(See Description)	1	Detection Circuit Cable-5' Cable ( <b>Supplier #439386</b> )
9	(See Description)	1	210 Control Module and Mounting Bracket ( <b>Supplier #439561</b> )

# LVS 210 FIRE SUPPRESSION SYSTEM ASSEMBLY AND INSTALLATION

## EMISSION SYSTEM - CONTROL MODULE AND CABLE LAYOUT

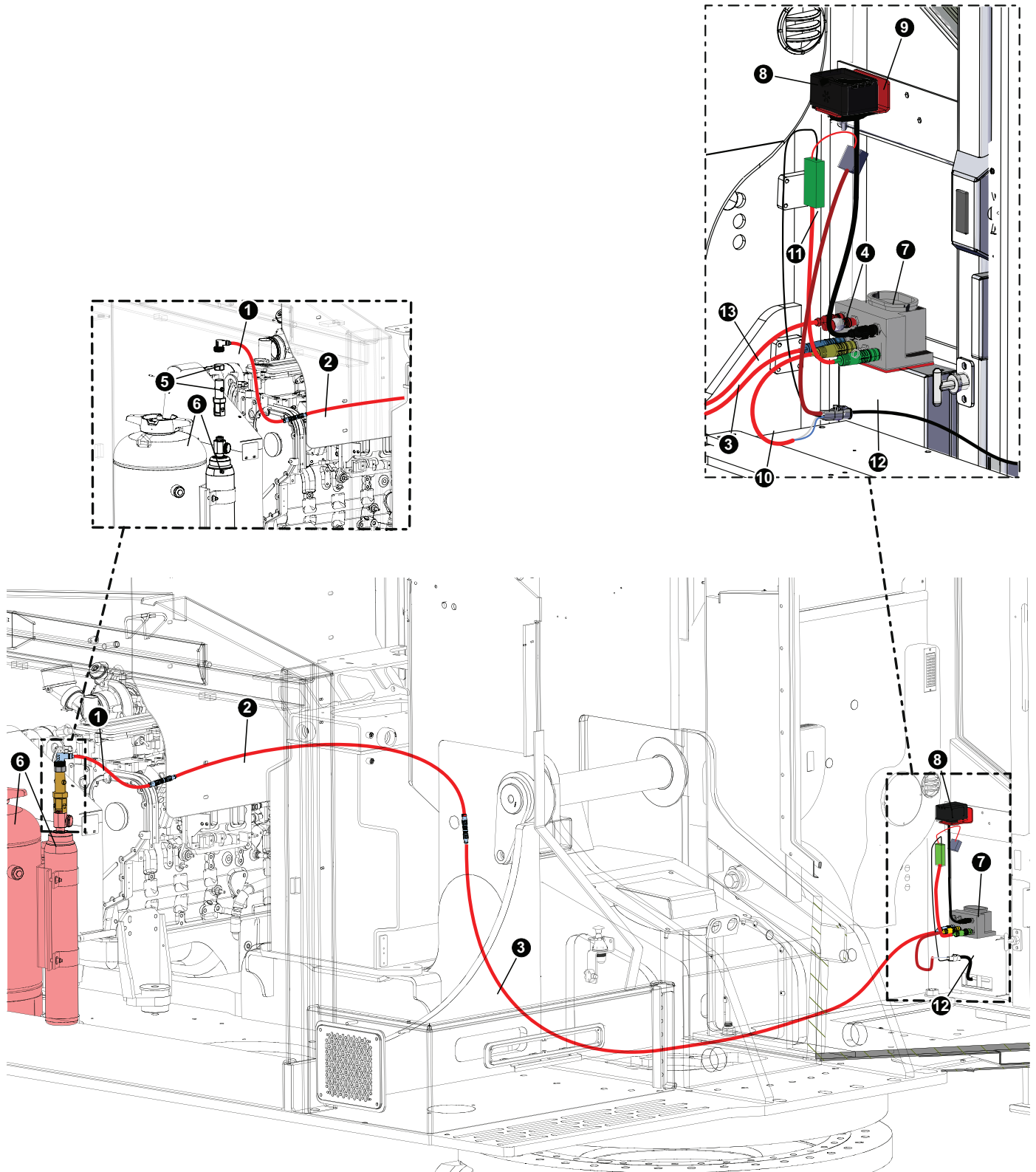

## LVS 210 FIRE SUPPRESSION SYSTEM ASSEMBLY AND INSTALLATION

### EMISSION SYSTEM - CONTROL MODULE AND CABLE LAYOUT

ITEM #	PART #	QTY.	DESCRIPTION
1	439430	1	Release Drop Cable-30" Cable Assy.
2	439420	1	Release Circuit-5' Cable
3	439422	1	Release Circuit-10' Cable Assy.
4	439396	1	Detection Circuit, End of Line (EOL) Connector
5	439569	1	Nozzle, EPA
6	438775	1	15 GAL Wet Chemical Tank w/ Mounted Nitrogen Tank
7	439561	1	210 Control Module and Mounting Bracket
8	439417	1	Checkfire-210 Control Module
9	46975	1	PLATE, CHECKFIRE BOX MTG
10	439466	1	Relay Circuit Cable
11	439422	1	Fused Power Circuit Cable
12	57736	1	Fire Suppression Harness
13			(See Previous Page for Cable)

**PAGE INTENTIONALLY LEFT BLANK**